

Simple Machines in Compound Machines

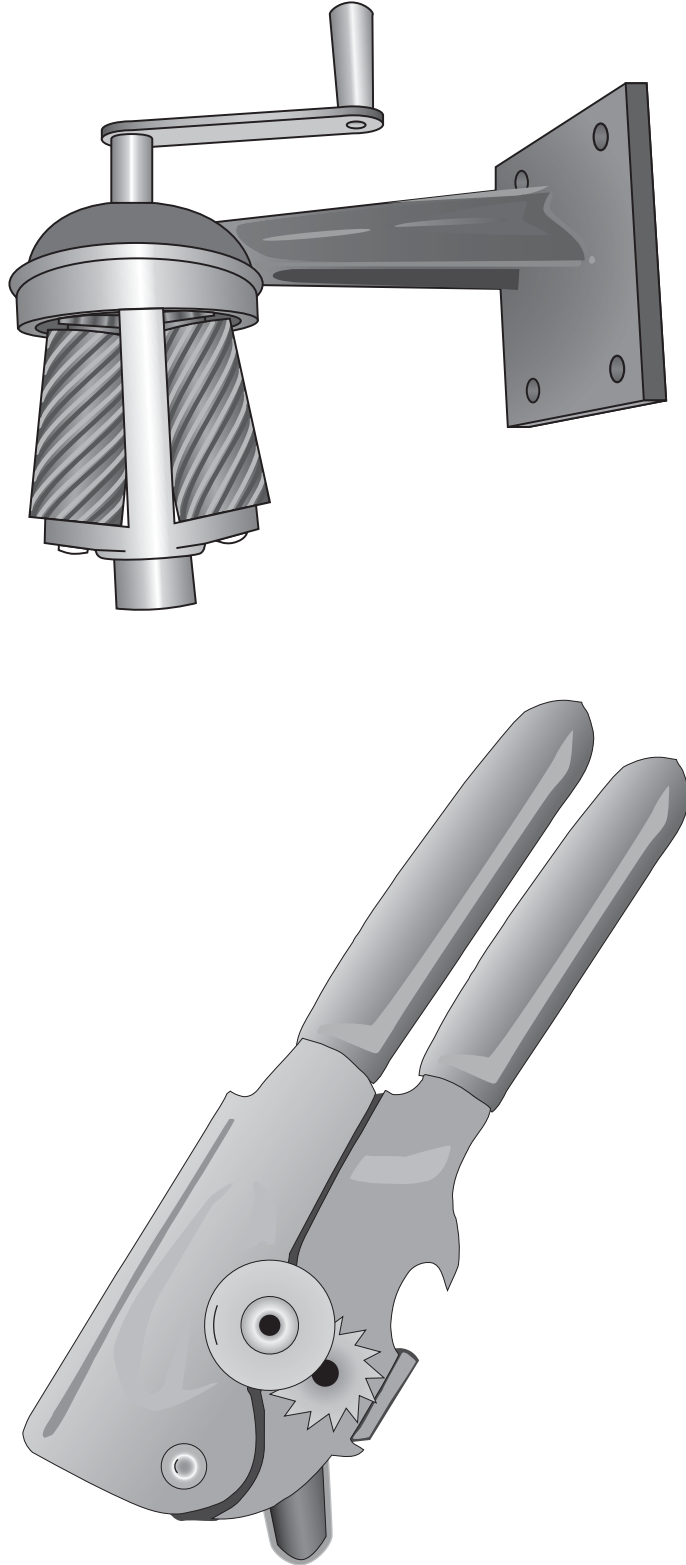

Copyright © Glencoe/McGraw-Hill, a division of The McGraw-Hill Companies, Inc.

10 Transparency 10-4 Worksheet

Simple Machines in Compound Machines

1. What is the definition of a compound machine?

2. How do you calculate mechanical advantage of a simple machine?

3. What is the relationship between the mechanical advantage of a compound machine and the mechanical advantage of the simple machines from which it is made?

4. In the compound machines shown, where are the simple machines listed below? What do they do?

- a. Can opener: wheel and axle, lever

- b. Pencil sharpener: wheel and axle, screw

5. How would you calculate the mechanical advantage of each of the compound machines shown?

- a. Can opener

- b. Pencil sharpener